

STATE OF NORTH CAROLINA  
DIVISION OF HIGHWAYS

STATE	STATE PROJECT REFERENCE NO.	SHEET NO.	TOTAL SHEETS
N.C.	33920.3.4	L1	11

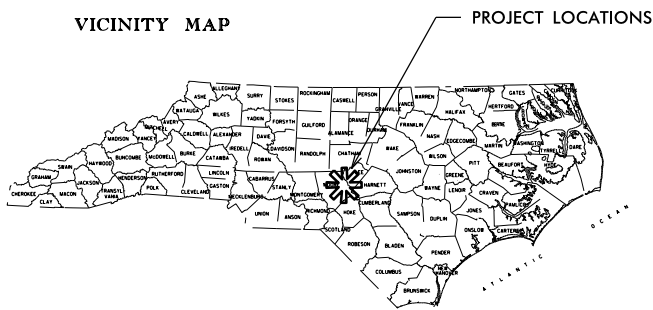

**MOORE & LEE COUNTY**

LOCATION: MULTIPLE LOCATIONS INCLUDING THE PINEHURST TRAFFIC CIRCLE  
TYPE OF WORK: BED PREPERATION, ANNUAL PLANTINGS, AND ESTABLISHMENT CARE

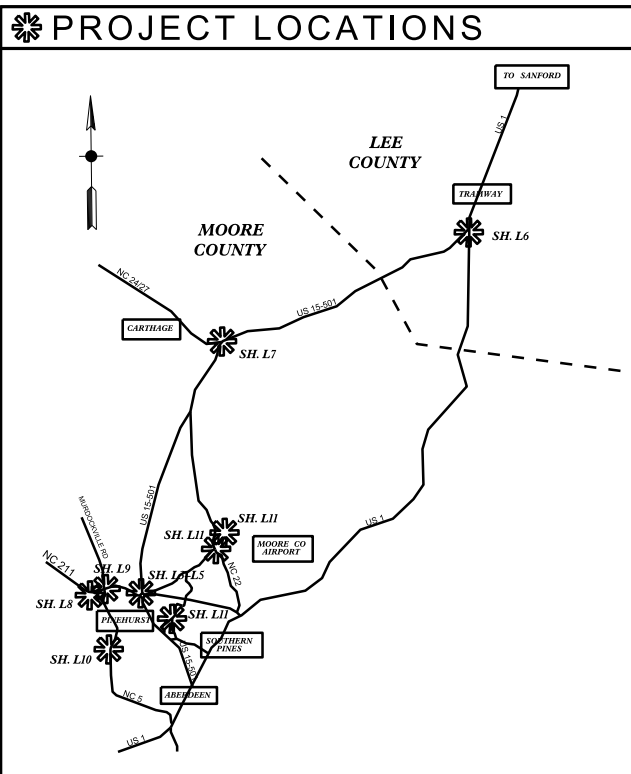

SUMMARY OF QUANTITIES

Quantity	Key	Plant Name	Common name	Spacing
300 EA	ABR	Alternanthera 'Brazilian Red Hots',	Brazilian Red Hot Alternanthera,	12" O.C.
5058 EA	BOR	Begonia 'Super Olympic Red',	Super Olympic Red Begonia,	12" O.C.
4490 EA	BOW	Begonia 'Super Olympic White',	Super Olympic White Begonia,	12" O.C.
890 EA	DGM	Duranta 'Gold Mound',	Gold Mound Duranta,	18" O.C.
2497 EA	IB	Ipomoea 'Blackie',	Blackie Sweet Potato Vine,	18" O.C.
345 EA	ITL	Ipomoea 'Terrace Lime',	Terrace Lime Sweet Potato Vine,	18" O.C.
2370 EA	PB	Petunia 'Easy Wave Blue',	Easy Wave Blue Petunia,	12" O.C.
5175 EA	PP	Petunia 'Easy Wave Pink',	Easy Wave Pink Petunia,	12" O.C.
6066 EA	PR	Petunia 'Easy Wave Red',	Easy Wave Red Petunia,	12" O.C.
7335 EA	PW	Petunia 'Easy Wave White',	Easy Wave White Petunia,	12" O.C.
225 EA	SVB	Salvia farinacea 'Victoria Blue',	Victoria Blue Salvia,	16" O.C.
38 EA	CKF	Calamagrostis x acutifolia 'Karl Foerster',	Karl Foerster Feather Reed Grass,	3' O.C.
133 EA	PSF	Pennisetum setaceum 'Fireworks',	Fireworks Pennisetum,	24" O.C.
650 CY		Topsoil		
204 CY		Mulch - Pine Bark Fines		

Notes:

Contractor and Engineer will coordinate delivery of the annuals prior to installation. Proposed time schedule and desired delivery locations will be agreed upon prior to initiation of work.

annuals delivered to site will include one extra flat of each annual Variety (to be used as replacement plant material as determined or directed by NCDOT engineer).

CONVENTIONAL SYMBOLS

County Line	---
City or Town Line	---
Exist. Right of Way Line Marker	△
Prop. Right of Way Line Marker (By Other)	▲
Prop Right of Way Line Marker (By Contract)	⊙
Exist. Control of Access Line	⊕
Prop. Control of Access Line	⊗
Property Line	---
Easement Line	---
Slope Stake Line	---
Exist. Fence	+
Prop. Woven Wire Fence	○
Prop. Chain Link Fence	○
Exist. Road	==
Prop. Road	==
Guardrail	---
Survey Line	---
Denotes Line Equality	---
Bridge	---
Culvert	---
Railroad	---
Woods	---
Exist. Telephone Pole	○
Prop. Telephone Pole	○
Tower Pole and Line	---
Exist. Power Pole	○
Prop. Power Pole	○
Sanitary Sewer Line	---
Water Line	---
Gas Line	---
Picnic Shelter	□
Regeneration	---
Reforestation	---

REVISIONS

DATE	DESCRIPTION

2004 American Standard for Nursery Stock  
2012 NCDOT STANDARD SPECIFICATIONS  
PREPARED IN THE OFFICE OF:  
NCDOT- ROADSIDE ENVIRONMENTAL UNIT  
LANDSCAPE DESIGN & DEVELOPMENT SECTION  
1557 MAIL SERVICE CENTER  
RALEIGH NC 27699 919-707-2935

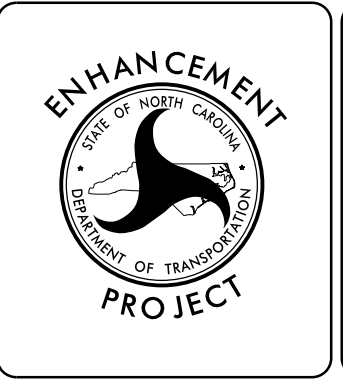
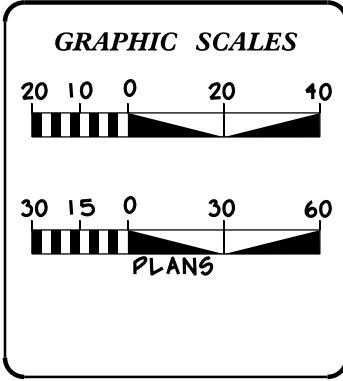

INDEX OF SHEETS :

TITLE, DESCRIPTION, & SUMMARY OF QUANTITIES	L1
CIRCLE LAYOUT & BED QUANTITIES	L2
DETAIL A&B PLAN	L3
DETAIL C,D, & E PLAN	L4

Prepared in the Office of:  
**ROADSIDE ENVIRONMENTAL UNIT**  
**DEPARTMENT OF TRANSPORTATION**  
**DIVISION OF HIGHWAYS**  
RALEIGH, N.C.  
**2012 STANDARD SPECIFICATIONS**  
Drawn By: RNK Design Section FEB-2014

NOTES:  
CONTRACTOR SHALL CONSULT THE DIVISIONS SPECIAL PROVISIONS FOR PROCEDURES FOR PREPARING ANNUAL BEDS, INSTALLATION, FUMIGATION AND PLANT BED AMENDMENTS. NO PROGRESS OF ANNUAL DEVELOPMENT OR INSTALLATION SHALL TAKE PLACE UNTIL THESE SPECIAL PROVISIONS ARE REVIEWED AND AGREED UPON.  
ALL ANNUALS SHALL BE SPACED ON 12" AND/OR 18" CENTERS. ANNUALS SHALL BE SET AT A PROPER POSITION AS REGARDS TO DEPTH TO PLANT TO SOIL LEVEL. SOIL SHALL BE FIRMLY PLACED AROUND PLANTS AND MULCH. 2" OF SOIL AMENDMENTS SHALL BE ADDED TO EACH PLANT BED AS DIRECTED BY THE ENGINEER IN THE FIELD. CONTRACTOR SHALL COORDINATE WITH THE ENGINEER TO DETERMINE PROPER DELIVERY DATES AND QUANTITIES OF ANNUALS TO THE PLANT BED AREAS.  
BEDDING PLANTS SHALL BE WATERED IN IMMEDIATELY FOLLOWING PLANTING OPERATION. NO PORTION OF PLANTING SHALL GO UN WATERED OVERNIGHT. (WATER IN SAME DAY AS PLANT INSTALLATION)

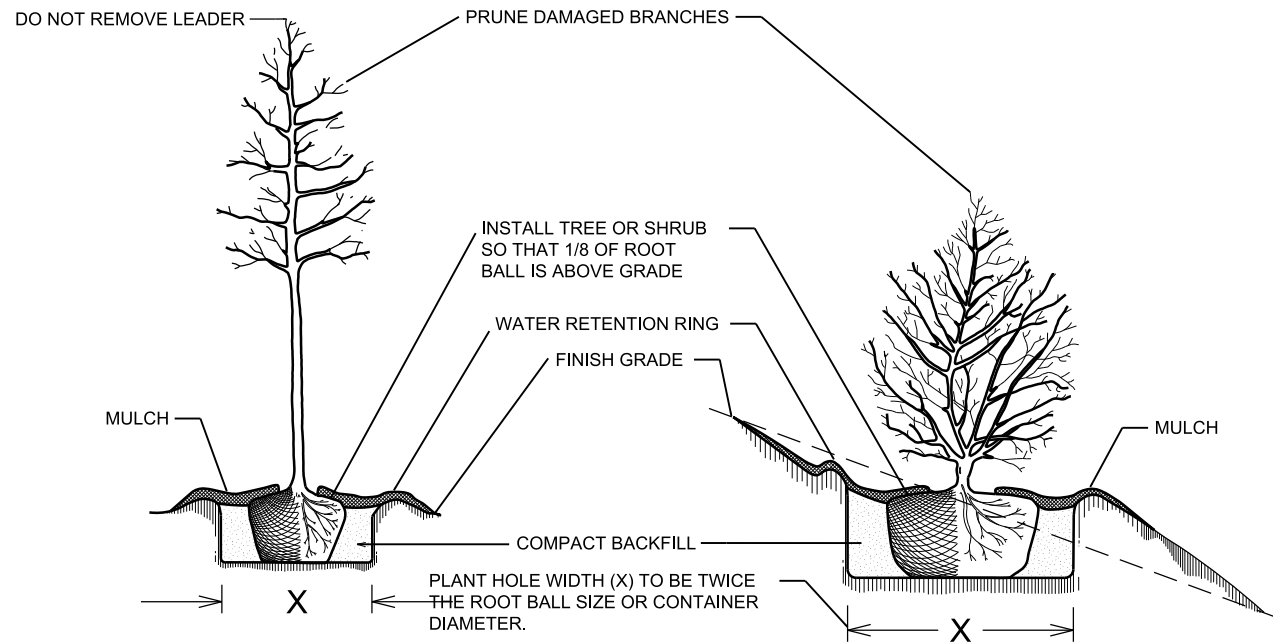

**TREE OR SHRUB PLANTING DETAIL**  
(LEVEL GROUND)

**TREE OR SHRUB PLANTING DETAIL**  
(SLOPING GROUND)

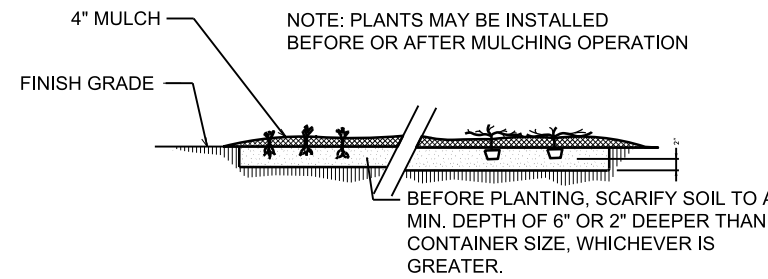

**GROUND COVER/ BEDDING**  
**PLANT DETAIL**

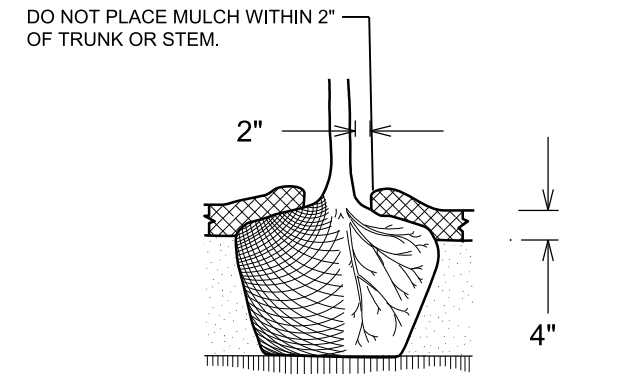

**MULCH DETAIL**

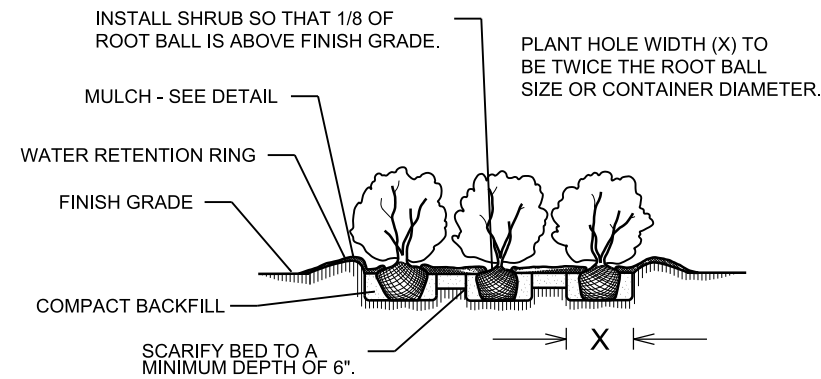

**SHRUB BED PLANTING DETAIL**

**NOTES:**

- ☛ SCHEDULE FOR PLANT HOLE SIZE: PLANT HOLE WIDTH (X) TO BE TWICE THE ROOT BALL SIZE OR CONTAINER DIAMETER.
- ☛ SEE STANDARD SPECIFICATIONS FOR PLANT BED FUMIGATION AND HERBICIDAL TREATMENT.
- ☛ APPLY FERTILIZER AT PLANTING TIME IN THE FORM OF A SLOW RELEASE PELLET OR TABLET. APPLY AT RATE RECOMMENDED BY MANUFACTURER. BOTH RATE AND FORMULATION MUST BE APPROVED BY FIELD ENGINEER PRIOR TO APPLICATION.
- ☛ REMOVE WIRE BASKET AND FOLD BURLAP BACK FROM TOP OF ROOT BALL BEFORE BACKFILLING IS COMPLETE.
- ☛ ALL PRUNING TO FOLLOW STANDARD ARBORICULTURAL PRACTICES AS SPECIFIED BY INTERNATIONAL SOCIETY OF ARBORICULTURE.
- ☛ DO NOT ATTEMPT TO STRAIGHTEN A TREE THAT HAS BEEN PLANTED AT AN ANGLE WITH THE USE OF STAKING OR GUYING. DIG TREE AND REPLANT TO UPRIGHT POSITION.

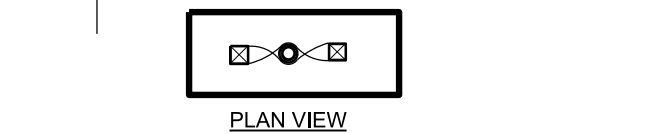
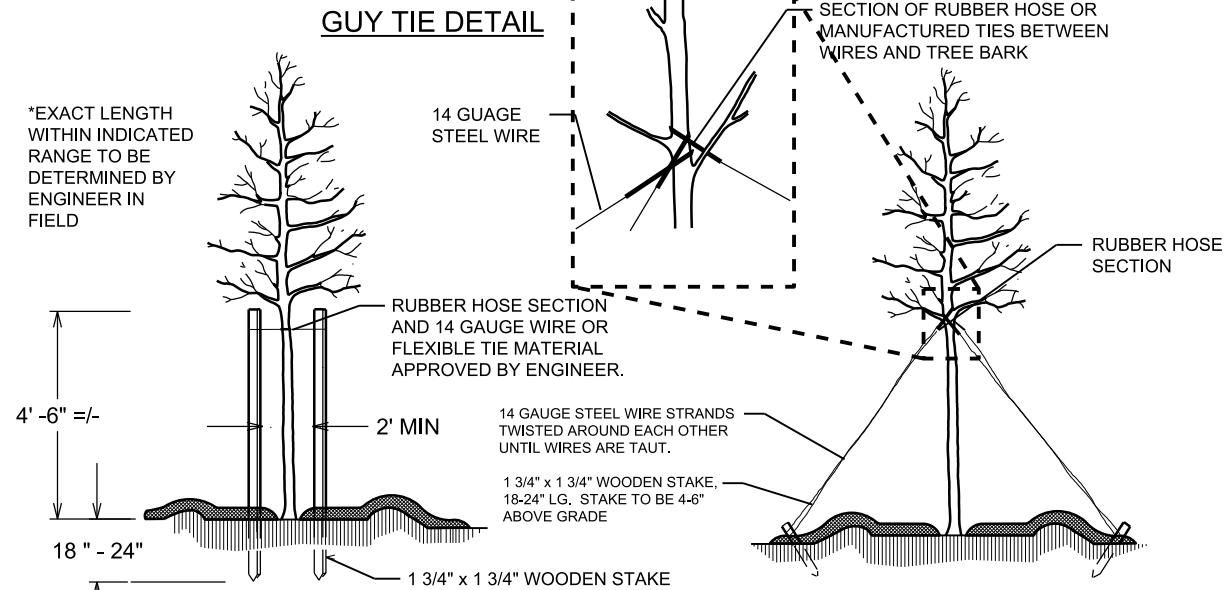

**STAKING DETAIL**  
(TREES 6'-10')

USE AS DIRECTED BY FIELD ENGINEER

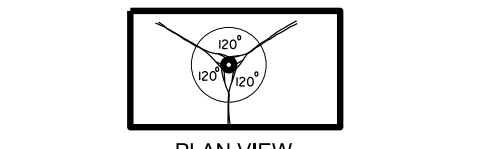

**GUYING DETAIL**  
(TREES 10' OR LARGER)

USE AS DIRECTED BY FIELD ENGINEER

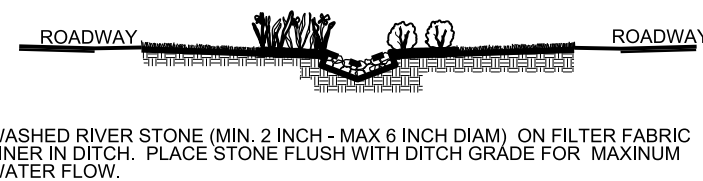

**RIVERSTONE**  
**DITCH LINING DETAIL**

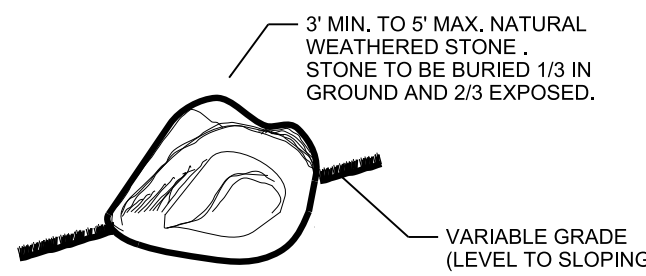

**BOULDER PLACEMENT DETAIL**  
**TYPICAL**

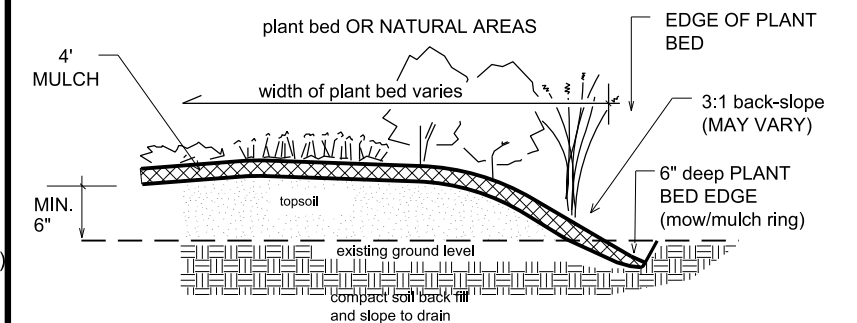

**PLANT BED EDGE DETAIL**

18-FEB-2014 11:08 S:\P\mgt\landscape\Contract\2014 Pinehurst Annuals - Spring\2014 Final Annual Design Plans.dgn jstrodler AT DSCAD-257160



ncdot - Roadside environmental unit  
landscape design & Development  
1557 mail service center raleigh nc 27699-1557  
ph: 919-707-2935 fax: 919-715-2554  
[http://www.ncdot.org/doh/operations/dp\\_chief\\_eng/roadside/](http://www.ncdot.org/doh/operations/dp_chief_eng/roadside/)

**Moore & Lee County Plantings**  
2014 Spring Annuals

contract #:

re u engineer  
**B. Kopetsky**  
sheet description:

prel. design date :	Feb/2014
checked by & date :	
final design date :	

PLANTING DETAILS
Landscape

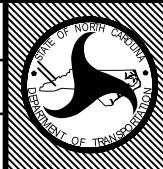

T.I.P. #	
WBS #	33920.3.4
FED I.D. #	STP-000S(720)
sheet no :	L2
total sheet no :	11

# PINEHURST TRAFFIC CIRCLE

## Island Reference Key

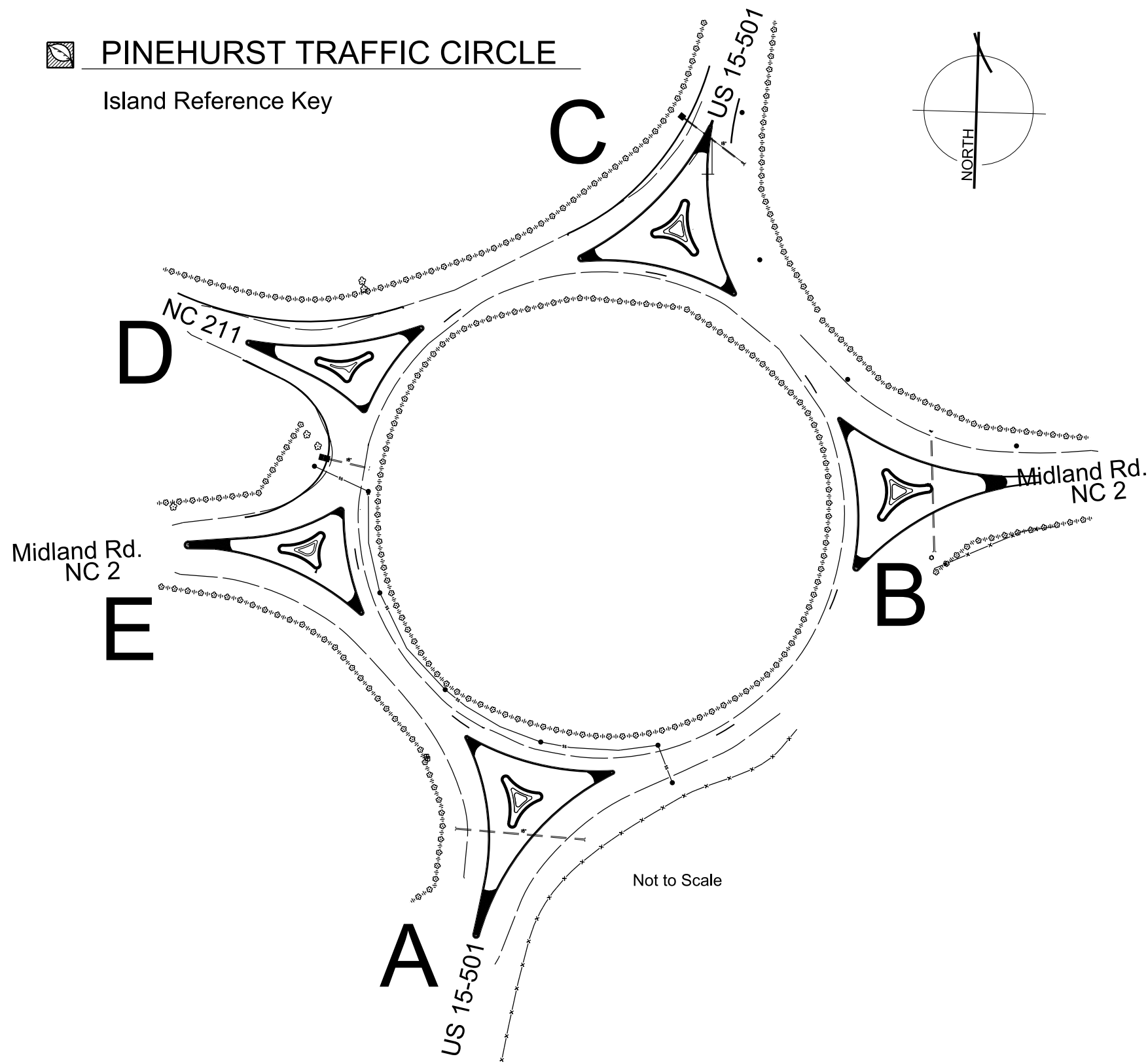

### QUANTITIES PER PLANT BED

Traffic Island A			
195	EA	IB	Ipomoea 'Blackie' Blackie Sweet Potato Vine 18" O.C.
195	EA	ITL	Ipomoea 'Terrace Lime' Terrace Lime Sweet Potato Vine 18" O.C.
46	EA	PSF	Pennisetum setaceum 'Fireworks' Fireworks Pennisetum 24" O.C.

Traffic Island B			
584	EA	BOR	Begonia 'Super Olympic Red' Super Olympic Red Begonia 12" O.C.
389	EA	BOW	Begonia 'Super Olympic White' Super Olympic White Begonia 12" O.C.
135	EA	SVB	Salvia farinacea 'Victoria Blue' Victoria Blue Salvia 16" O.C.

Traffic Island C			
270	EA	IB	Ipomoea 'Blackie' Blackie Sweet Potato Vine 18" O.C.
150	EA	ITL	Ipomoea 'Terrace Lime' Terrace Lime Sweet Potato Vine 18" O.C.
55	EA	PSF	Pennisetum setaceum 'Fireworks' Fireworks Pennisetum 24" O.C.

Traffic Island D			
225	EA	BOR	Begonia 'Super Olympic Red' Super Olympic Red Begonia 12" O.C.
238	EA	BOW	Begonia 'Super Olympic White' Super Olympic White Begonia 12" O.C.
120	EA	DGM	Duranta 'Gold Mound' Gold Mound Duranta 18" O.C.

Traffic Island E			
300	EA	ABR	Alternanthera 'Brazilian Red Hots' Brazilian Red Hot Alternanthera 12" O.C.
75	EA	PR	Petunia 'Easy Wave Red' Easy Wave Red Petunia 12" O.C.
240	EA	PW	Petunia 'Easy Wave White' Easy Wave White Petunia 12" O.C.
90	EA	SVB	Salvia farinacea 'Victoria Blue' Victoria Blue Salvia 16" O.C.
32	EA	PSF	Pennisetum setaceum 'Fireworks' Fireworks Pennisetum 24" O.C.

18-FEB-2014 11:08 S:\ProjMgmt\Landscape\_Contracts\2014 Pinehurst Annuals - Spring\2014 Final Annual Design Plans.dgn jstoder AT DBCAD-257160



ncdot - Roadside environmental unit  
 landscape design & Development  
 1557 mail service center raleigh nc 27699-1557  
 ph: 919-707-2920 fax: 919-715-2554  
[http://www.ncdot.org/doh/operations/dp\\_chief\\_eng/roadside/](http://www.ncdot.org/doh/operations/dp_chief_eng/roadside/)

**Moore & Lee County Plantings**  
 2014 Spring Annuals

contract #:

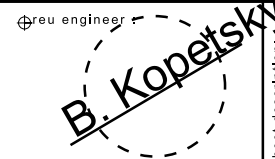

prel. design date :	Feb/2014
checked by & date :	
final design date :	

TRAFFIC CIRCLE ISLANDS
Circle Reference Key



T.I.P. #	
WBS #	33920.3.4
FED I.D. #	STP-000S(720)
sheet no :	L3
total sheet no :	11

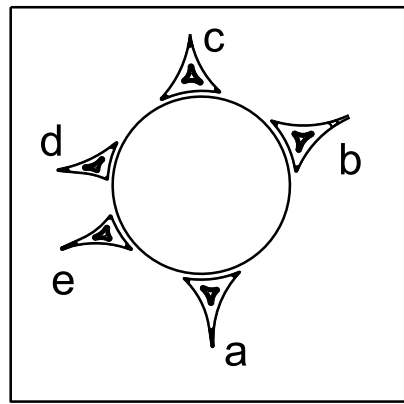

**PINEHURST TRAFFIC CIRCLE**

**A**

US 15-501 South

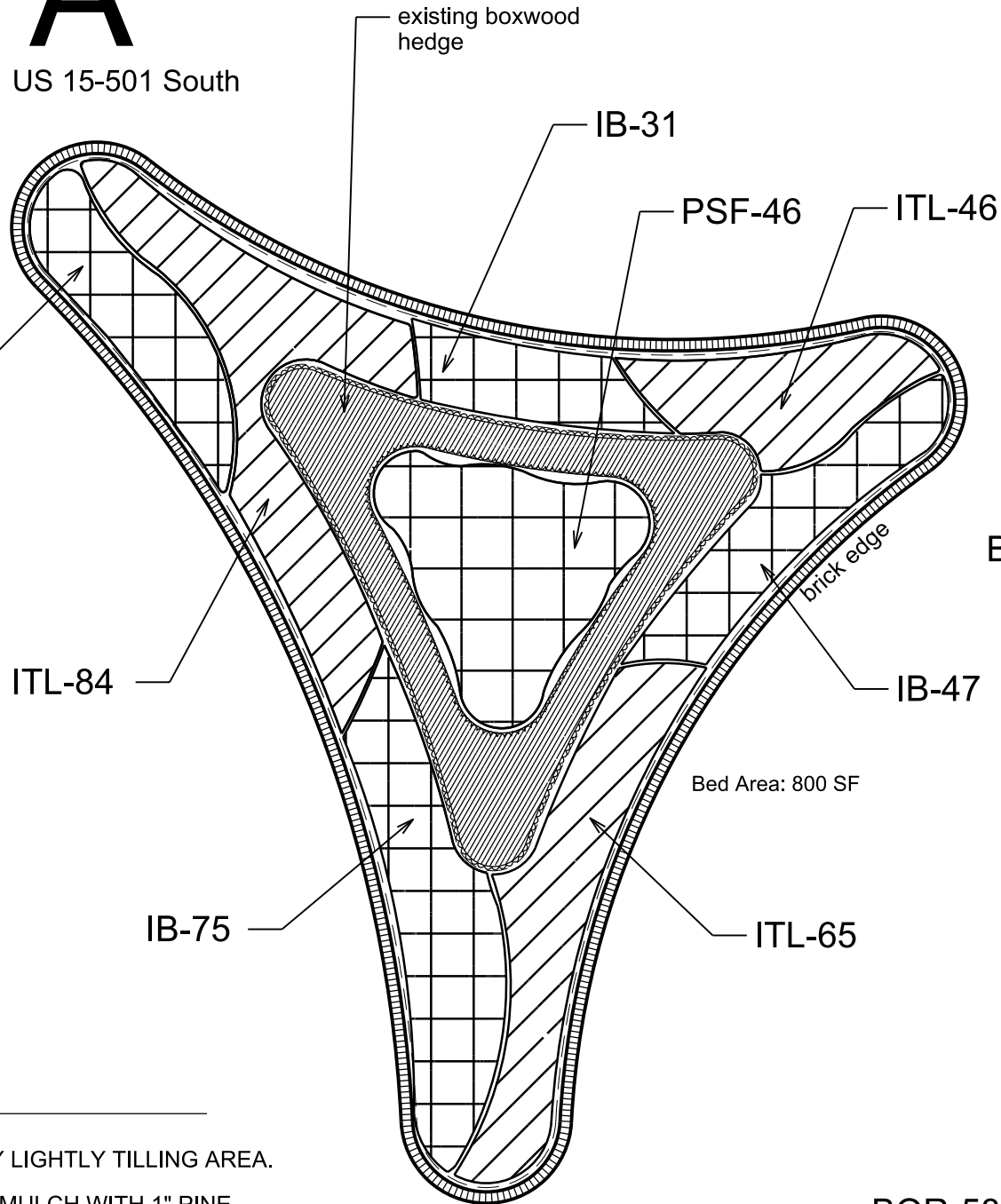

BOR-171

**B**

Midland Road East

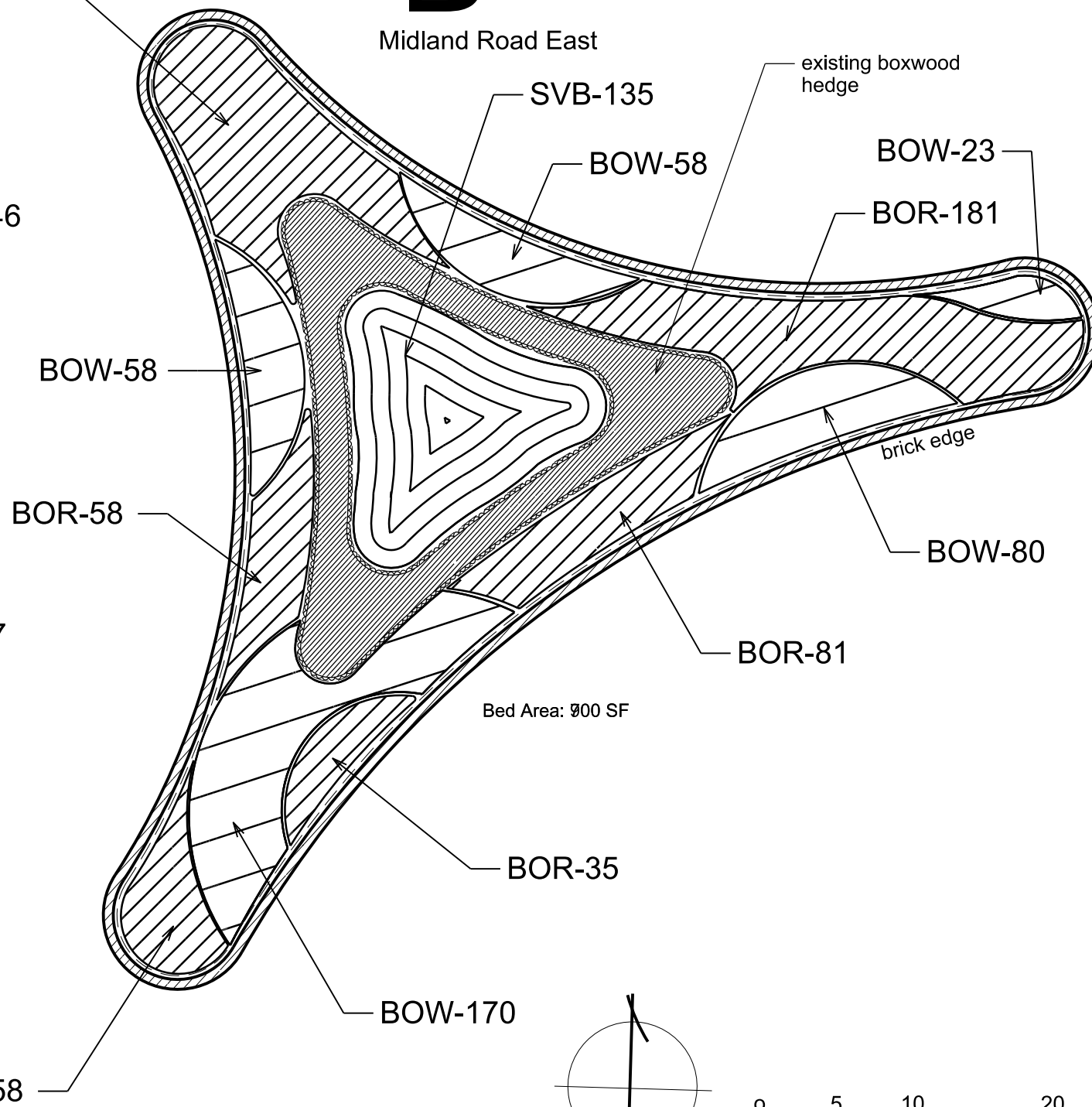

**NOTES**

- PREPARE PLANT BED BY LIGHTLY TILLING AREA.
- SUPPLEMENT EXISTING MULCH WITH 1" PINE BARK FINES.



18-FEB-2014 11:08 S:\Proj\mgmt\landscape\_Contracts\2014 Pinehurst Annuals - Spring\2014 Final Annual Design Plans.dgn jefroder AT DBCAD-257160



ncdot - Roadside environmental unit  
 landscape design & Development  
 1557 mail service center raleigh nc 27699-1557  
 ph: 919-733-2920 fax: 919-733-9810  
[http://www.ncdot.org/doh/operations/dp\\_chief\\_eng/roadside/](http://www.ncdot.org/doh/operations/dp_chief_eng/roadside/)

**Moore & Lee County Plantings**  
 2014 Spring Annuals

contract #:

preu engineer  
**B. Kopetsky**

sheet description:	prel. design date: Feb/2014
	checked by & date:
	final design date:

TRAFFIC CIRCLE ISLANDS
Interior Plant Beds
ISLAND A & B



T.I.P. #	
WBS #	33920.3.4
FED I.D. #	STP-000S(720)
sheet no.:	L4
total sheet no.:	11

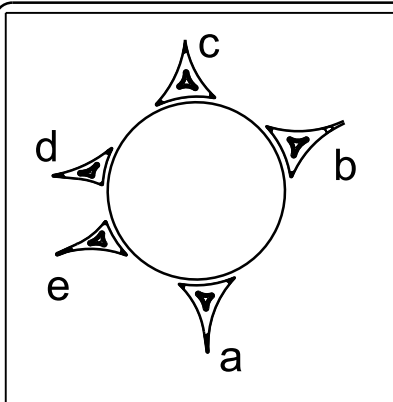

**PINEHURST TRAFFIC CIRCLE**

**C**

US 15-501 North

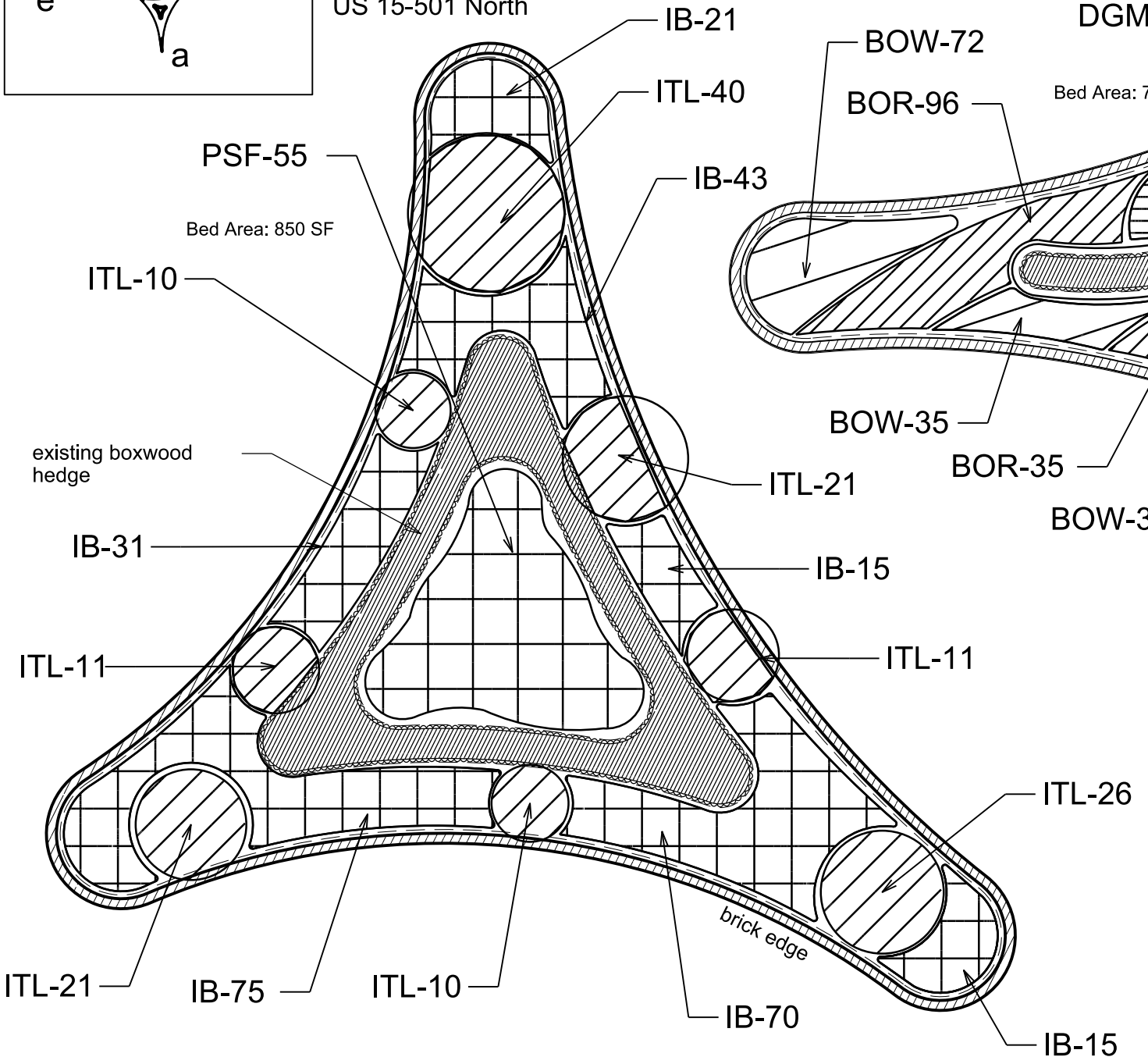

**D**

NC 211 West

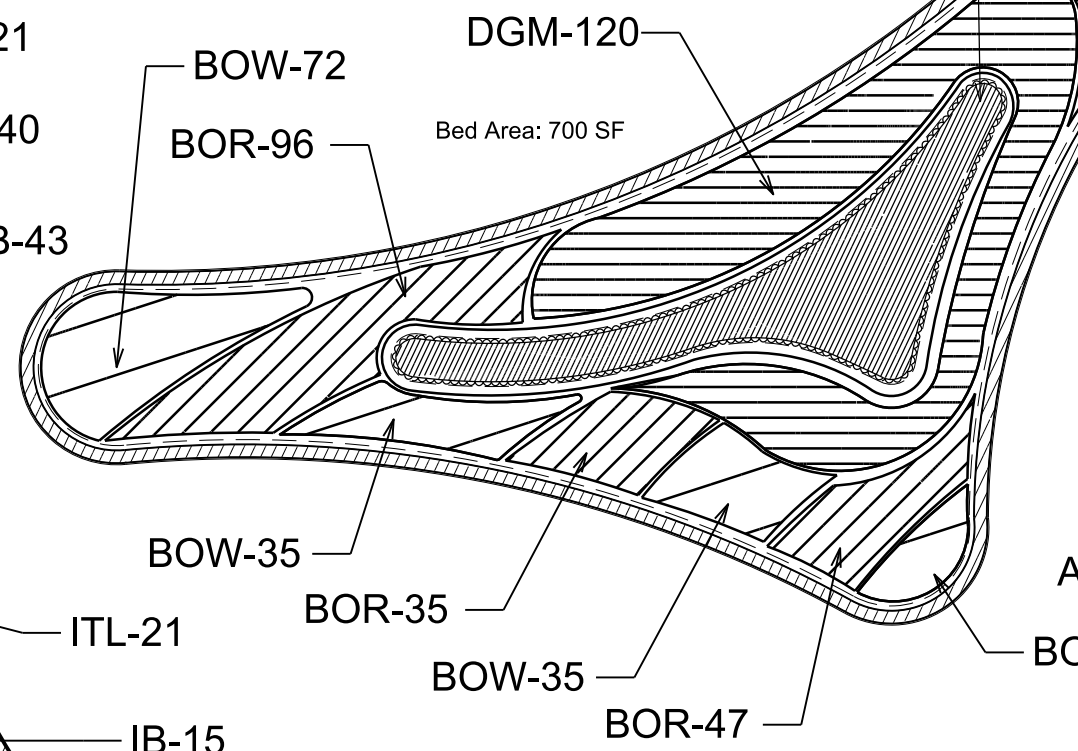

**E**

Midland Road West

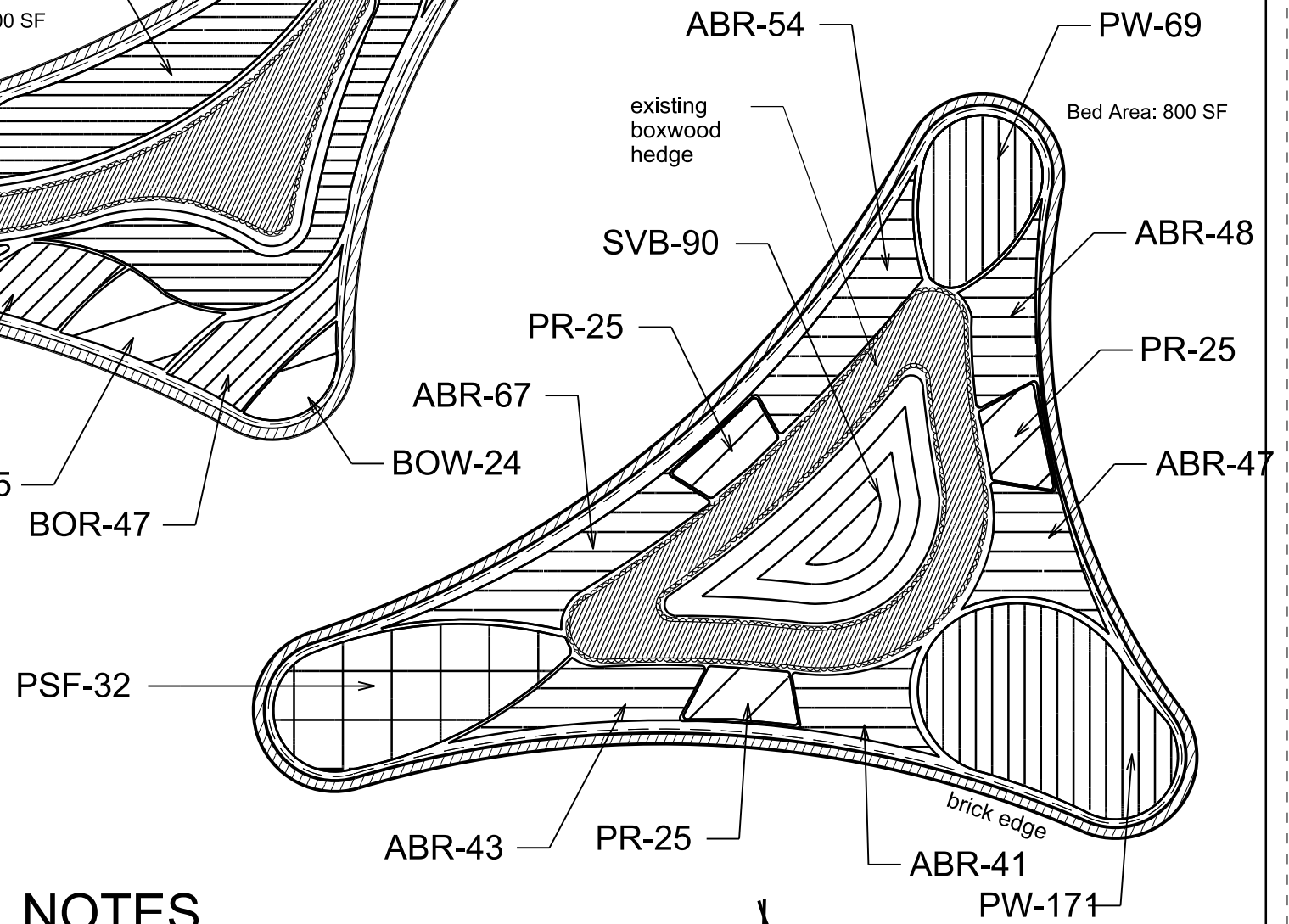

**NOTES**

- PREPARE PLANT BED BY LIGHTLY TILLING AREA.
- SUPPLEMENT EXISTING MULCH WITH 1" PINE BARK FINES.

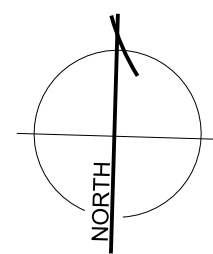

18-FEB-2014 11:08 S:\Projects\Landscapes\2014 Pinehurst Annuals - Spring\2014 Final Annual Design Plans.dgn jefreder AT DBCAD-257160



ncdot - Roadside environmental unit  
 landscape design & Development  
 1557 mail service center raleigh nc 27699-1557  
 ph: 919-733-2920 fax: 919-733-9810  
[http://www.ncdot.org/doh/operations/dp\\_chief\\_eng/roadside/](http://www.ncdot.org/doh/operations/dp_chief_eng/roadside/)

**Moore & Lee County Plantings**  
 2014 Spring Annuals  
 contract #:

preu engineer  
**B. Kopetsky**

prel. design date :	Feb/2014
checked by & date :	
final design date :	

TRAFFIC CIRCLE ISLANDS
Interior Plant Beds
ISLAND C, D, & E

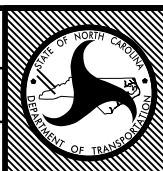

T.I.P. #	
WBS #	33920.3.4
FED I.D. #	STP-000S(720)
sheet no.:	L5
total sheet no.:	11

**US 1 @ US 15-501 SOUTH OF TRAMWAY**

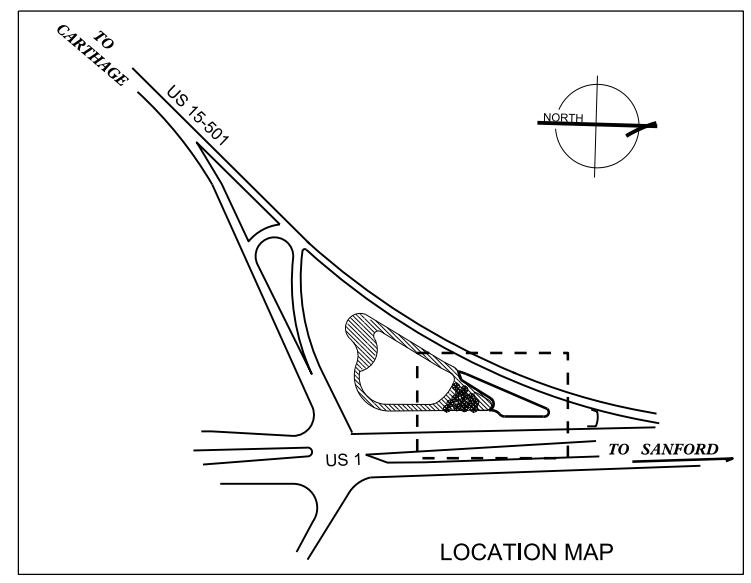
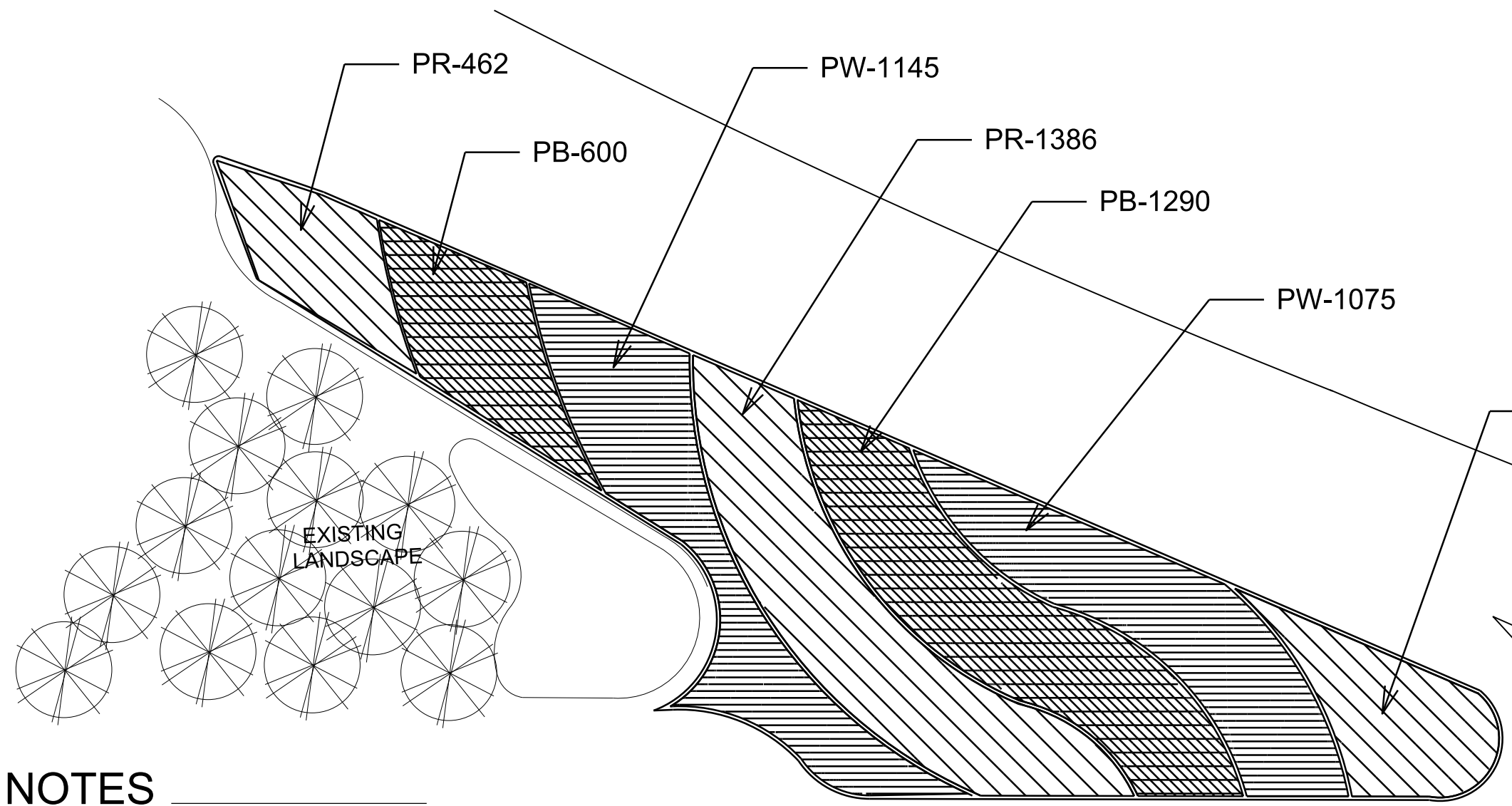

**NOTES**

- APPLY HERBICIDAL TREATMENT IN PROPOSED BED AREA PRIOR TO BED PREPERATION.
- PREPARE PLANT BED BY TILLING AND INTEGRATING 12" OF APPROVED TOPSOIL.
- MULCH ANNUAL PLANTINGS WITH 2" PINE BARK FINES.

Annual Planting  
Bed Area: 6030 SF

**Plant Quantities**

US 1 @ US 15-501					
1890	EA	PB	Petunia 'Easy Wave Blue'	Easy Wave Blue Petunia	12" O.C.
2436	EA	PR	Petunia 'Easy Wave Red'	Easy Wave Red Petunia	12" O.C.
2220	EA	PW	Petunia 'Easy Wave White'	Easy Wave White Petunia	12" O.C.

**US 1**



18-FEB-2014 11:08 S:\ProjMgmt\Landscapes\_Contracts\2014 Pinehurst Annuals - Spring\2014 Final Annual Design Plans.dgn jfrodier AT DBCAD-257160



ncdot - Roadside environmental unit  
landscape design & Development  
1557 mail service center raleigh nc 27699-1557  
ph: 919-707-2920 fax: 919-715-2554  
[http://www.ncdot.org/doh/operations/dp\\_chief\\_eng/roadside/](http://www.ncdot.org/doh/operations/dp_chief_eng/roadside/)

**Moore & Lee County Plantings**  
2014 Spring Annuals

contract #:

preu engineer  
**B. Kopetsky**

sheet description:	prel. design date : Feb/2014	SPLIT @ US 1 & US 15-501	T.I.P. #
	checked by & date :	SOUTH OF TRAMWAY	WBS # 33920.3.4
	final design date :	ANNUAL PLANTING LAYOUT	FED I.D. # STP-000S(720)
			sheet no : total sheet no : L6 11

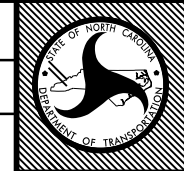

**US 15-501 & NC 24-27 @ CARTHAGE**

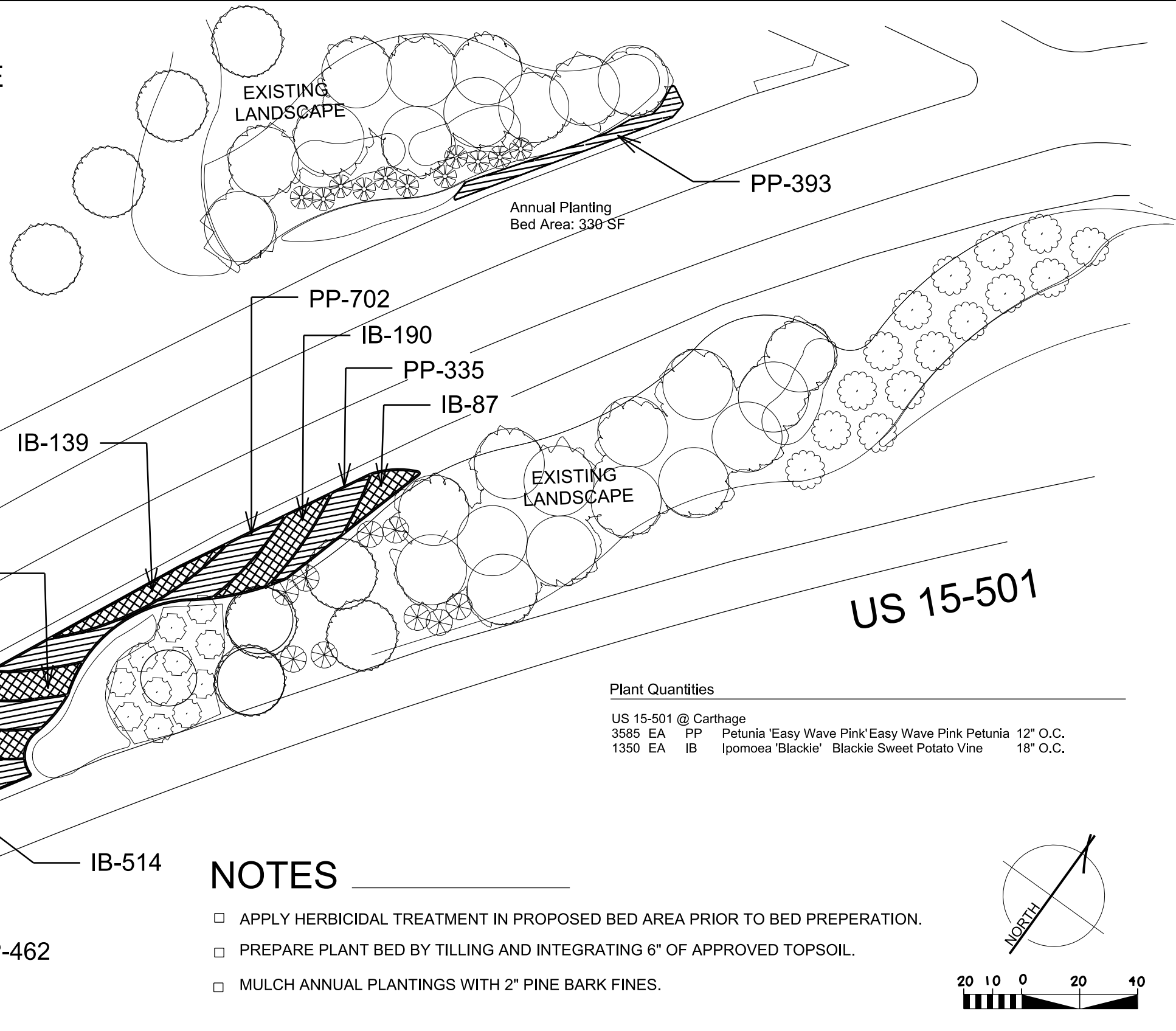
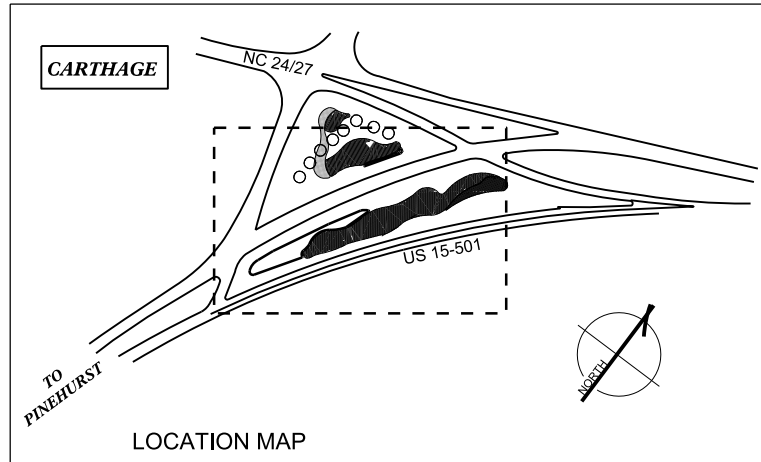

**Plant Quantities**

US 15-501 @ Carthage			
3585	EA	PP	Petunia 'Easy Wave Pink' Easy Wave Pink Petunia 12" O.C.
1350	EA	IB	Ipomoea 'Blackie' Blackie Sweet Potato Vine 18" O.C.

**NOTES**

- APPLY HERBICIDAL TREATMENT IN PROPOSED BED AREA PRIOR TO BED PREPERATION.
- PREPARE PLANT BED BY TILLING AND INTEGRATING 6" OF APPROVED TOPSOIL.
- MULCH ANNUAL PLANTINGS WITH 2" PINE BARK FINES.

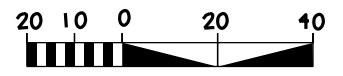
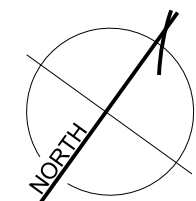

**TO PINEHURST  
US 15-501**

18-FEB-2014 11:08 S:\Projects\18-FEB-2014 Landscape Contracts\2014 Pinehurst Annuals - Spring\2014 Final Annual Design Plans.dgn jfrodor AT DBCAD-257160



ncdot - Roadside environmental unit  
landscape design & Development  
1557 mail service center raleigh nc 27699-1557  
ph: 919-707-2920 fax: 919-715-2554  
[http://www.ncdot.org/doh/operations/dp\\_chief\\_eng/roadside/](http://www.ncdot.org/doh/operations/dp_chief_eng/roadside/)

**Moore & Lee County Plantings**  
2014 Spring Annuals  
contract #:

engineer  
**B. Kopetsky**

prel. design date :	Feb/2014
checked by & date :	
final design date :	

traffic islands
CARTHAGE, US 15-501
ANNUAL PLANTING LAYOUT

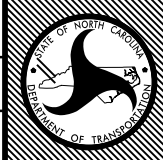

T.I.P. #	
WBS #	33920.3.4
FED I.D. #	STP-000S(720)
sheet no.:	L7
total sheet no.:	11

NC 211 @ NC 5

NC 211

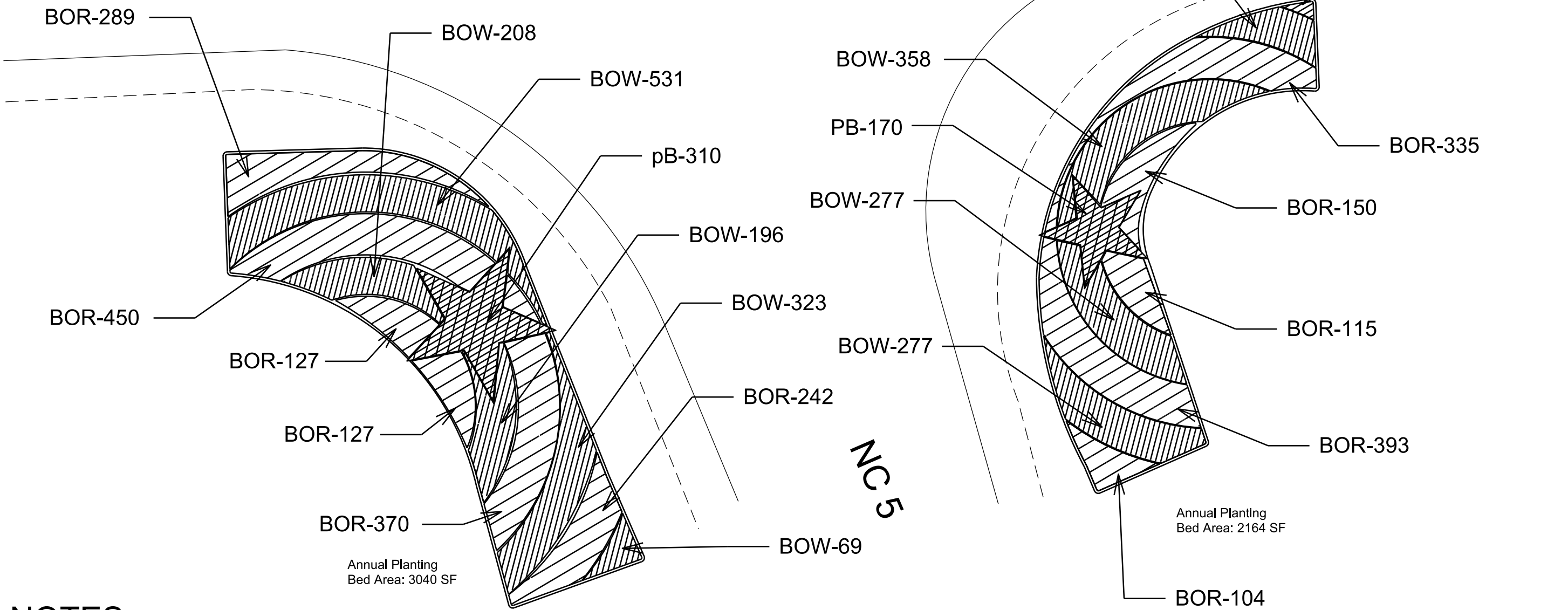

Annual Planting  
Bed Area: 3040 SF

Annual Planting  
Bed Area: 2164 SF

## NOTES

- APPLY HERBICIDAL TREATMENT IN PROPOSED BED AREA PRIOR TO BED PREPERATION.
- PREPARE PLANT BED BY TILLING AND INTEGRATING 6" OF APPROVED TOPSOIL.
- MULCH ANNUAL PLANTINGS WITH 2" PINE BARK FINES.
- PLACEMENT OF PLANT BED MAY NEED ADJUSTING IN THE FIELD DUE TO RECENT ROAD CONSTRUCTION. STAKE OUT PLANTING PRIOR TO INSTALLATION FOR NCDOT ENGINEER REVIEW AND APPROVAL..

### Plant Quantities

NC 211 @ NC 5					
2719	EA	BOR	Begonia 'Super Olympic Red'	Super Olympic Red Begonia	12" O.C.
2378	EA	BOW	Begonia 'Super Olympic White'	Super Olympic White Begonia	12" O.C.
480	EA	PB	Petunia 'Easy Wave Blue'	Easy Wave Blue Petunia	12" O.C.

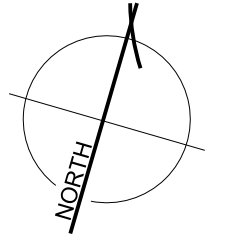

18-FEB-2014 11:08 S:\Projects\2014 Landscape Contracts\2014 Pinehurst Annuals - Spring\2014 Final Annual Design Plans.dgn jfrodor AT DBCAD-257160



ncdot - Roadside environmental unit  
landscape design & Development  
1557 mail service center raleigh nc 27699-1557  
ph: 919-707-2920 fax: 919-715-2554  
[http://www.ncdot.org/doh/operations/dp\\_chief\\_eng/roadside/](http://www.ncdot.org/doh/operations/dp_chief_eng/roadside/)

**Moore & Lee County Plantings**  
2014 Spring Annuals  
contract #:

preu engineer  
**B. Kopetsky**

prel. design date :	Feb/2014
checked by & date :	
final design date :	

NC 5 @ NC 211  
ANNUAL PLANTING LAYOUT

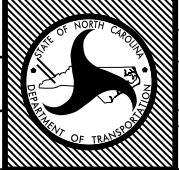

T.I.P. #	
WBS #	33920.3.4
FED I.D. #	STP-000S(720)
sheet no.:	L8
total sheet no.:	11



 **NC 211 @ MURDOCKSVILLE RD.**

**NOTES**

- APPLY HERBICIDAL TREATMENT IN PROPOSED BED AREA PRIOR TO BED PREPERATION.
- PREPARE PLANT BED BY TILLING AND INTEGRATING 6" - 12" OF APPROVED TOPSOIL.
- MULCH ANNUAL PLANTINGS WITH 2" PINE BARK FINES.
- PLACEMENT OF PLANT BED MAY NEED ADJUSTING IN THE FIELD DUE TO RECENT ROAD CONSTRUCTION. STAKE OUT PLANTING PRIOR TO INSTALLATION FOR NCDOT ENGINEER REVIEW AND APPROVAL..

**Plant Quantities**

NC 211 @ Murdocksville Rd			
1530	EA	BOR	Super Olympic Red Begonia 12" O.C.
1485	EA	BOW	Super Olympic White Begonia 12" O.C.
38	EA	CKF	Karl Foerster Feather Reed Grass 3' O.C.

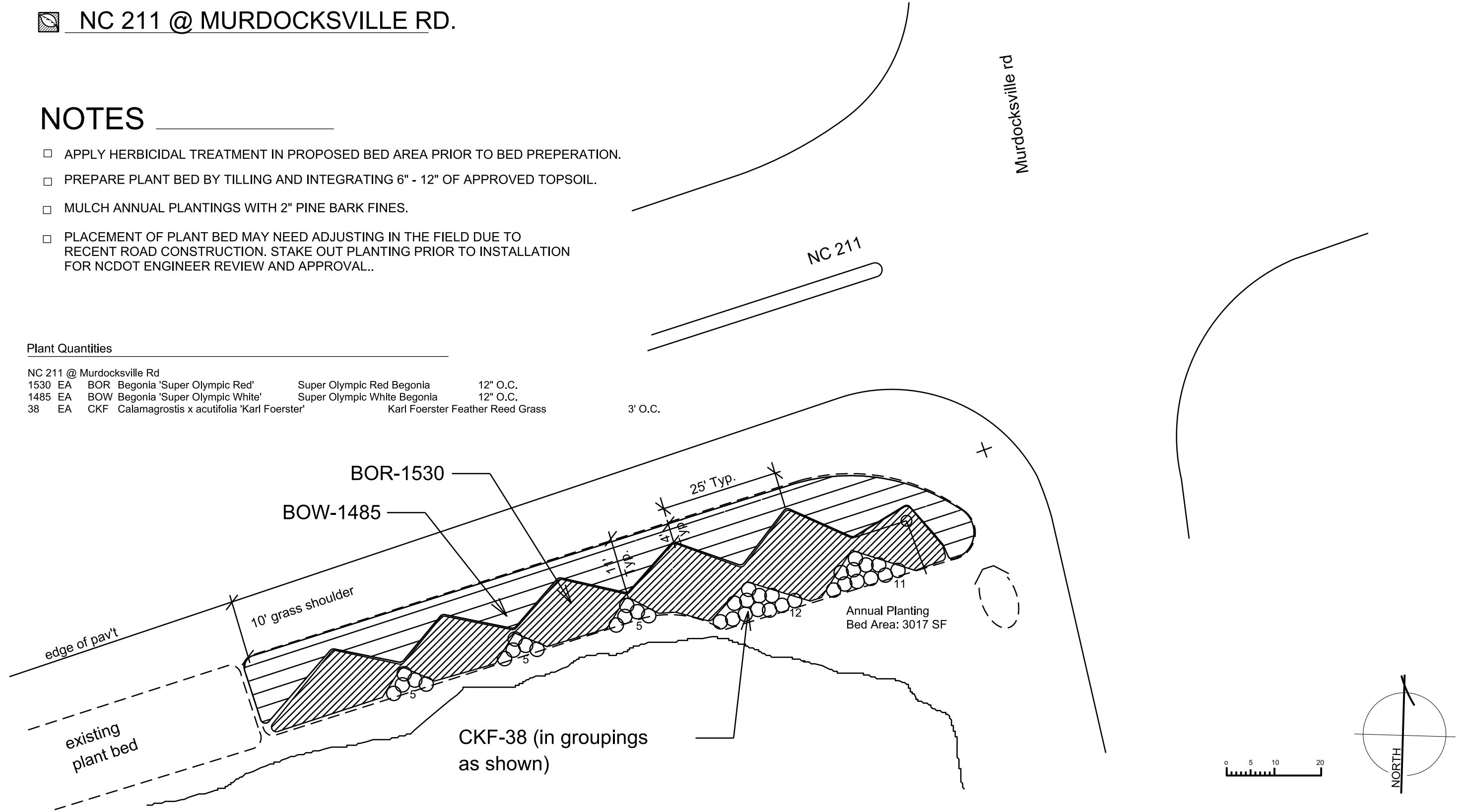

18-FEB-2014 11:08 S:\Prof\mgmt\landscape\_Contracts\2014 Pinehurst Annuals - Spring\2014 Final Annual Design Plans.dgn jfrodor AT DBCAD-257160



ncdot - Roadside environmental unit  
 landscape design & Development  
 1557 mail service center raleigh nc 27699-1557  
 ph: 919-707-2920 fax: 919-715-2554  
[http://www.ncdot.org/doh/operations/dp\\_chief\\_eng/roadside/](http://www.ncdot.org/doh/operations/dp_chief_eng/roadside/)

**Moore & Lee County Plantings**  
 2014 Spring Annuals  
 contract #:

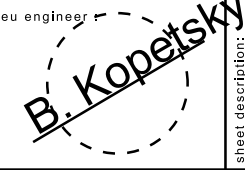
freu engineer  

sheet description:	prel. design date : Feb/2014
	checked by & date :
	final design date :

NC 211 @ MURDOCKVILLE
ANNUAL PLANTING LAYOUT

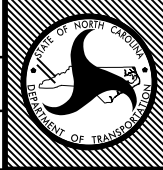

T.I.P. #	
WBS #	33920.3.4
FED I.D. #	STP-000S(720)
sheet no.:	L9
total sheet no.:	11

# NC 5 @ DEPOT

## NOTES

- APPLY HERBICIDAL TREATMENT IN PROPOSED BED AREA PRIOR TO BED PREPERATION.
- PREPARE PLANT BED BY TILLING AND INTEGRATING 6" OF APPROVED TOPSOIL.
- MULCH ANNUAL PLANTINGS WITH 2" PINE BARK FINES.

DURING INSTALLATION ENSURE THAT MEASURES ARE TAKEN TO AVOID THE EXISTING IRRIGATION SYSTEM. CONSULT WITH ENGINEER IN THE FIELD TO MAKE PROPER ADJUSTMENTS.

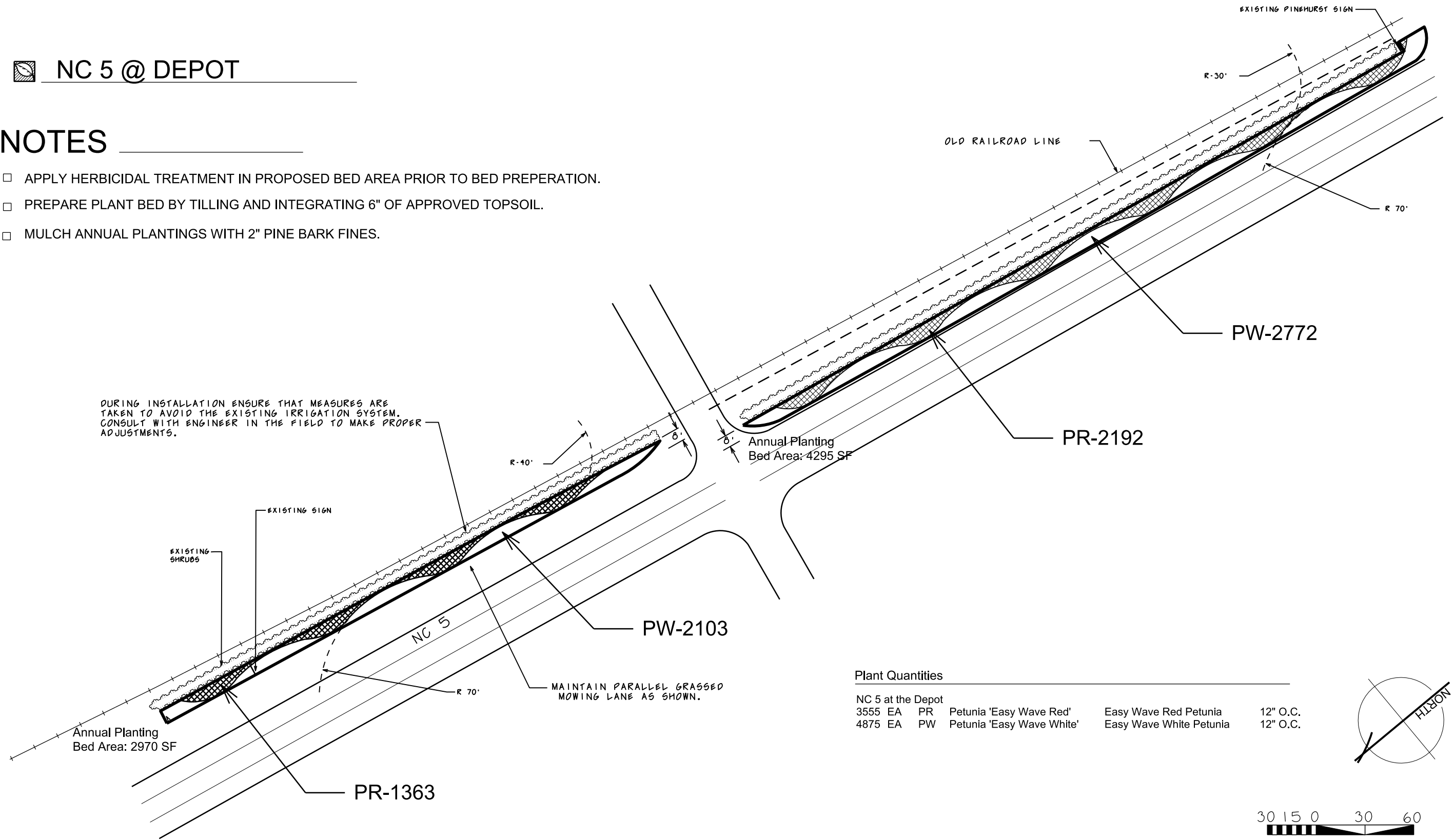

### Plant Quantities

NC 5 at the Depot					
3555	EA	PR	Petunia 'Easy Wave Red'	Easy Wave Red Petunia	12" O.C.
4875	EA	PW	Petunia 'Easy Wave White'	Easy Wave White Petunia	12" O.C.

18-FEB-2014 11:08 S:\Proj\mgmt\landscape\_Contracts\2014 Pinehurst Annuals - Spring\2014 Final Annual Design Plans.dgn jfrodor AT DBCAD-257160



ncdot - Roadside environmental unit  
 landscape design & Development  
 1557 mail service center raleigh nc 27699-1557  
 ph: 919-707-2920 fax: 919-715-2554  
[http://www.ncdot.org/doh/operations/dp\\_chief\\_eng/roadside/](http://www.ncdot.org/doh/operations/dp_chief_eng/roadside/)

**Moore & Lee County Plantings**  
 2014 Spring Annuals

contract #:

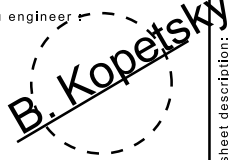
engineer  

sheet description:	prel. design date: Feb/2014	NC 5 @ THE DEPOT
	checked by & date:	ANNUAL PLANTING LAYOUT
	final design date:	

T.I.P. #	33920.3.4
WBS #	STP-000S(720)
FED I.D. #	
sheet no.:	total sheet no.:
L10	11

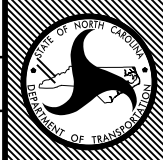

T.I.P. #	33920.3.4
WBS #	STP-000S(720)
FED I.D. #	
sheet no.:	total sheet no.:
L10	11

## MOORE COUNTY AIRPORT

11 CRAPE MYRTLE PLANTING BEDS ON AVIATION DR.

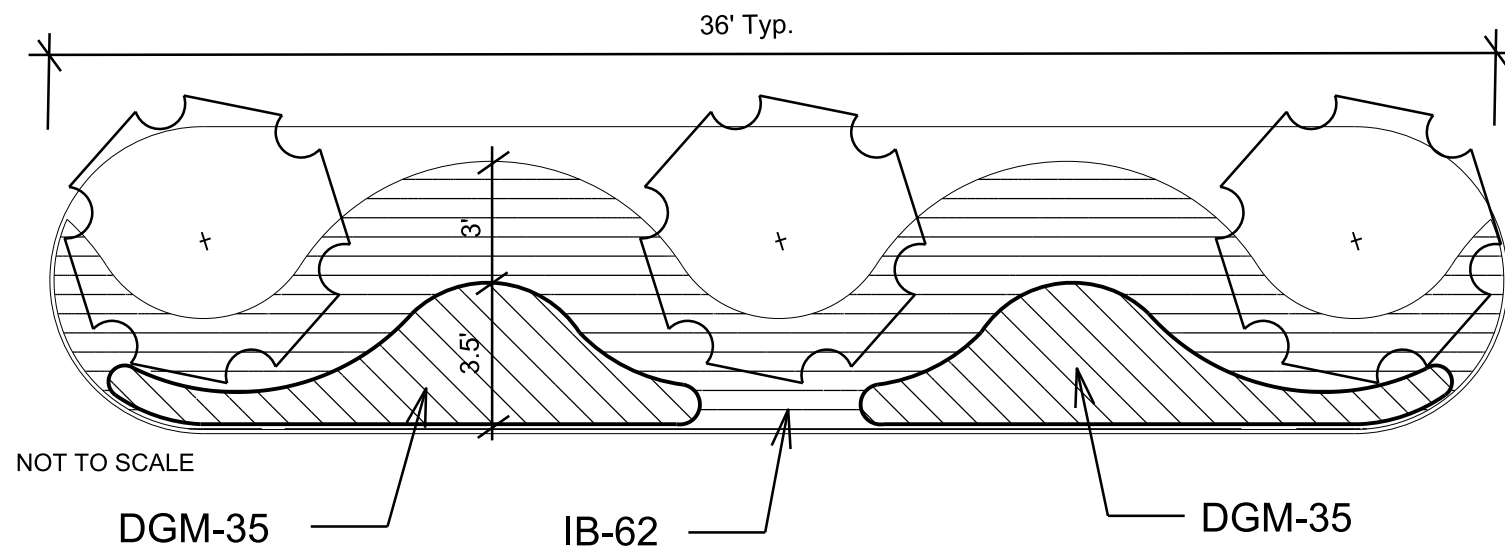

- Area for Annuals= 162 SF
- Repeat Detail at Each Crape Myrtle Plant Bed

### Plant Quantities

Aviation Dr. Crape Myrtle Beds			
770	EA	DGM	Duranta 'Gold Mound' Gold Mound Duranta 12" O.C.
682	EA	IB	Ipomoea 'Blackie' Blackie Sweet Potato Vine 18" O.C.

Roundabout- NC 22 @ Airport			
900	EA	PP	Petunia 'Easy Wave Pink' Easy Wave Pink Petunia 12" O.C.

Roundabout- Knoll Rd. Near Pinecrest H.S.			
690	EA	PP	Petunia 'Easy Wave Pink' Easy Wave Pink Petunia 12" O.C.

## NOTES

- PREPARE PLANT BEDS BY LIGHTLY TILLING AREA.
- MULCH ANNUAL PLANTINGS WITH 2" PINE BARK FINES.

## MOORE COUNTY ROUNDABOUTS (2 LOCATIONS)

- NC 22 @ AIRPORT
- KNOLL RD. (NEAR PINECREST H.S.)

PP-300 (AIRPORT)  
PP-230 (HIGH SCHOOL)

SUB PINK WAVE PETUNIAS  
FOR DAYLILIES (TYPICAL  
EACH LOCATION)  
REMOVE DAYLILIES (MIN.  
DAMAGE) & PROVIDE TO  
NCDOT.

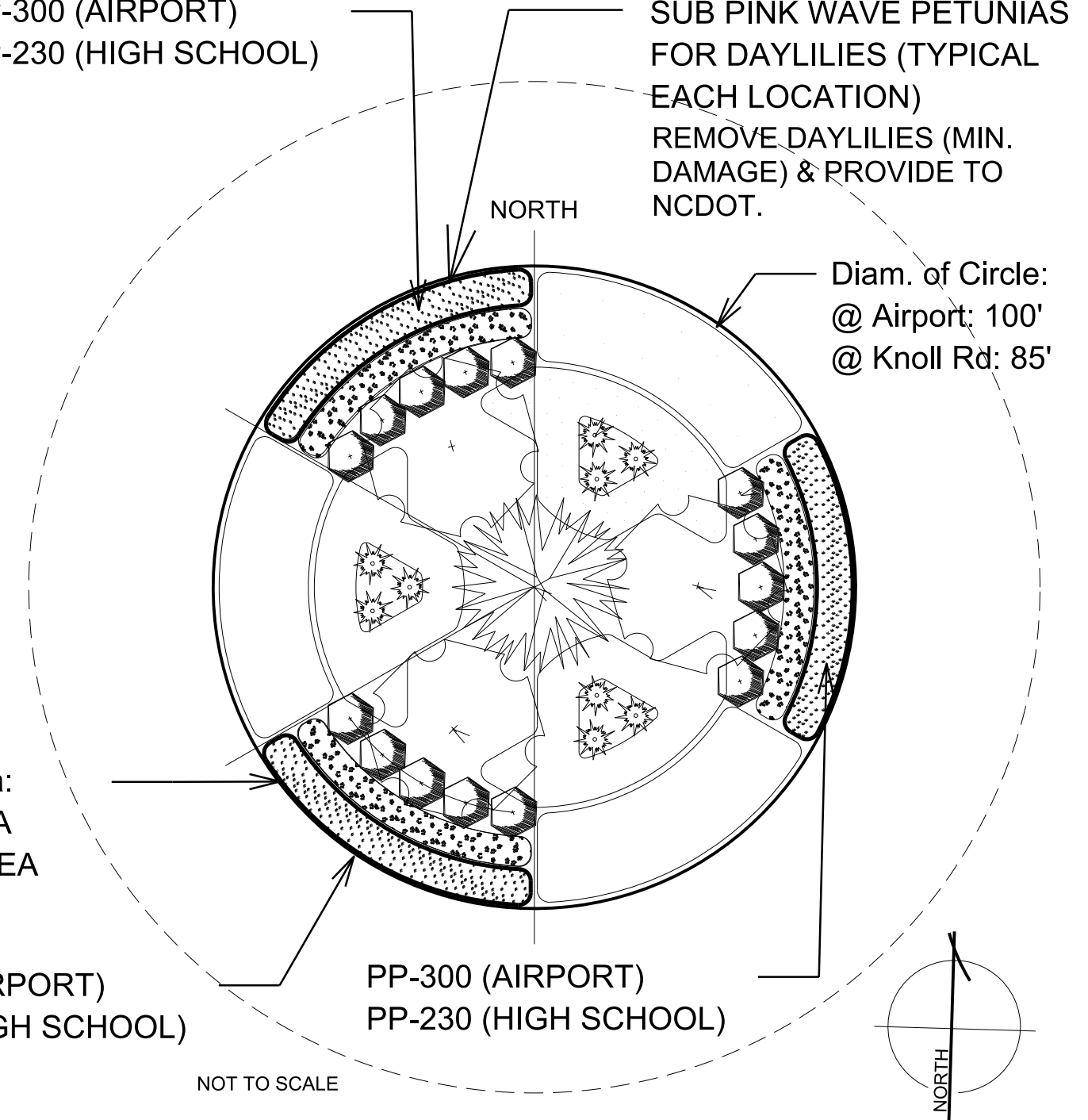

Annual Planting Area:  
@ Airport: 260 SF EA  
@ Knoll Rd: 200 SF EA

PP-300 (AIRPORT)  
PP-230 (HIGH SCHOOL)

PP-300 (AIRPORT)  
PP-230 (HIGH SCHOOL)

18-FEB-2014 11:08 S:\Prof\Mgmt\Landscapes\Projects\2014 Pinehurst Annuals - Spring\2014 Final Annual Design Plans.dgn jstoder AT DBCAD-257160



ncdot - Roadside environmental unit  
landscape design & Development  
1557 mail service center raleigh nc 27699-1557  
ph: 919-707-2920 fax: 919-715-2554  
[http://www.ncdot.org/doh/operations/dp\\_chief\\_eng/roadside/](http://www.ncdot.org/doh/operations/dp_chief_eng/roadside/)

Moore & Lee County Plantings  
2014 Spring Annuals

contract #:

freu engineer  
**B. Kopetsky**

prel. design date :	Feb/2014
checked by & date :	
final design date :	

TRAFFIC CIRCLE ISLANDS
CIRCLE REFERENCE KEY

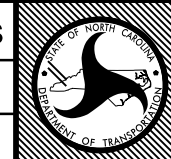

T.I.P. #	
WBS #	33920.3.4
FED I.D. #	STP-000S(720)
sheet no. :	L11
total sheet no. :	11